



LOW POWER CURRENT TRANSFORMER

Belle Vue Works, Boundary Street, Manchester, M12 5NG, UK T: 0044 (0)161 230 6363 F: 0044 (0)161 230 6464 E: relays@pbsigroup.com W: www.pbsigroup.com

P&B Protection Relays offer a range of Low Power Current Transformers (LPCT) which are compatible with the following intelligent motor overload relays: Motorvision, Micromotor and Primacon.

P&B's LPCTs are designed to IEC61869-10 and provide protection class accuracy.

Being passive devices, they do not require a separate power supply and provide an output of 225mV at the rated primary input current.

The CTs can be specified and used in LV motor control compartments in place of conventional ring type CTs with 1A or 5A rated secondaries. The advantage of the LPCT is their comparative size to the equivalent conventional CT allowing easier fitment into often cramped LV compartments.

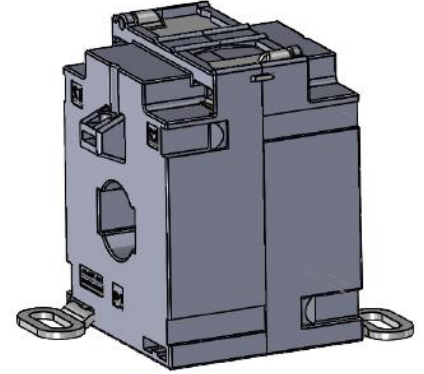

Phase LPCT	Protection Class 5P10
LPCT162DM	20A:225mV (FLC 12A-24A)
LPCT162DM	50A:225mV (FLC 25A-60A)
LPCT162DM	80A:225mV (FLC 48A-96A)
LPCT162DM	130A:225mV (FLC 78A-156A)
LPCT162DM	200A:225mV (FLC 120A-240A)

- Din Rail or Foot Mount
- Sealable Terminal Covers
- Rated System voltage 0.72/3kV

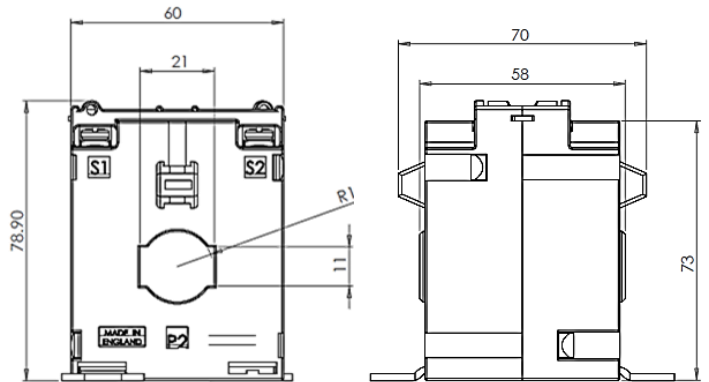

Recommended for motor full load current (FLC) between 60% to 120% of In

Core Balance CT	Protection Class 5P5
LPCT174DM	50A:225mV (EF In 1%-100%)

- Din Rail or Foot Mount
- Sealable Terminal Covers
- Rated System voltage 0.72/3kV

Aperture size = 31x31mm
 Max. individual conductor cable diameter = 15.6mm

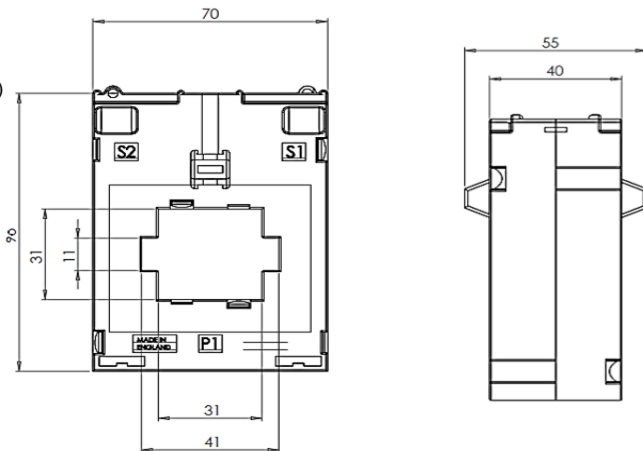

Issue 1 May 2019
 Low Power Current Transformers